



62 South Quarter Drive Loganlea QLD

6 🛏 4 🚿 4 🚗

Situated in an emerging pocket of the ever-growing suburb of Loganlea, this duplex is the ideal buy and forget investment, with a fantastic weekly return of \$750!

Hallmarks:

- Two car accommodation per unit
- Security screens and doors throughout
- Fully fenced yard spaces overlooking parklands
- Air-conditioning throughout
- NO BODY CORP.
- One Rates Notice

Unit 1:

- Open plan living & dining space with air-conditioning & ceiling fan
- Kitchen with island bench, gas cooking & dishwasher
- Three well-sized bedrooms all with ceiling fans & built-ins



Price : \$ 770,000
Land Size : 600 sqm
View : <https://www.kingcompanypg.com/sale/qld/logan/loganlea/residential/semi-detached/6755754>

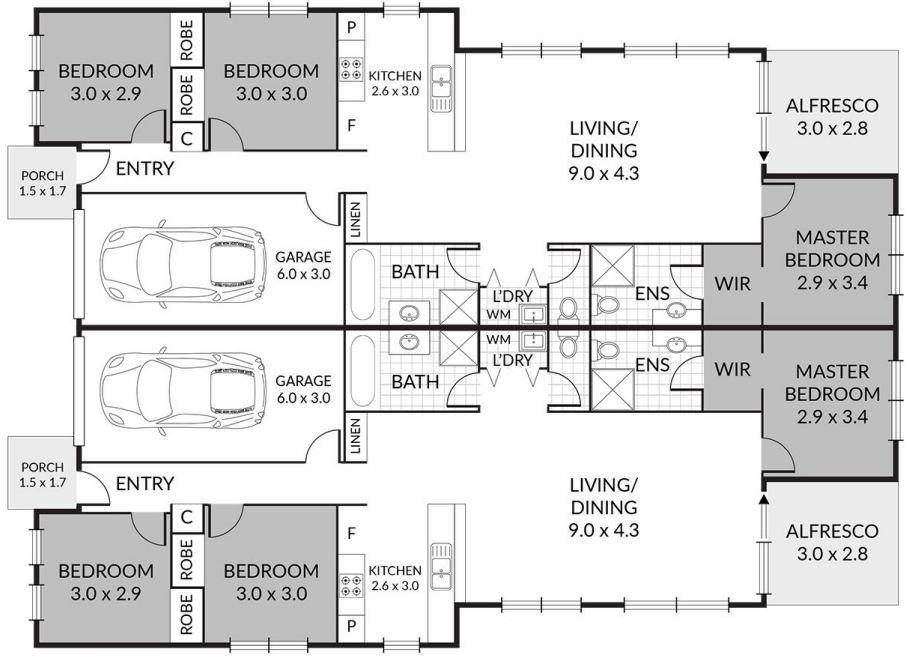

Courtney King
07 3805 2755



62 South Quarter Drive Loganlea

Internal: 221m² 6 x 
 External: 22m² 4 x 
 Total: 243m² 2 x 

KING & COMPANY
 Property Group

Note: Every precaution has been taken to verify the accuracy of the above details. However, prospective purchasers are advised to make their own enquiries.