



19 Richmond Crescent Waterford QLD

4 2 2

Situated a stones throw from the Woodlands Parklands and in a street surrounded by quality homes, this one needs to be on your list to inspect this weekend!

Price : \$ 395,000

View : <https://www.kingcompanypg.com/sale/qld/logan/waterford/residential/house/6760649>

Property Features:

- ~ Open plan living space with air-conditioning
- ~ Great central kitchen with gas cooking and breakfast bar
- ~ Four bedrooms all with built-in robes & ceiling fans
- ~ Master bedroom with ensuite & walk-in robe + air-conditioning
- ~ Main bathroom with bathtub + separate toilet
- ~ Great outdoor alfresco area off living space
- ~ Low maintenance yard with entertaining deck + garden shed

Additional Features:

- ~ 6kw SOLAR Power



Courtney King
07 3805 2755

Internal 162m² External 16m² Total 178m²

19 Richmond Crescent, **Waterford**



4 x 2 x 2 x

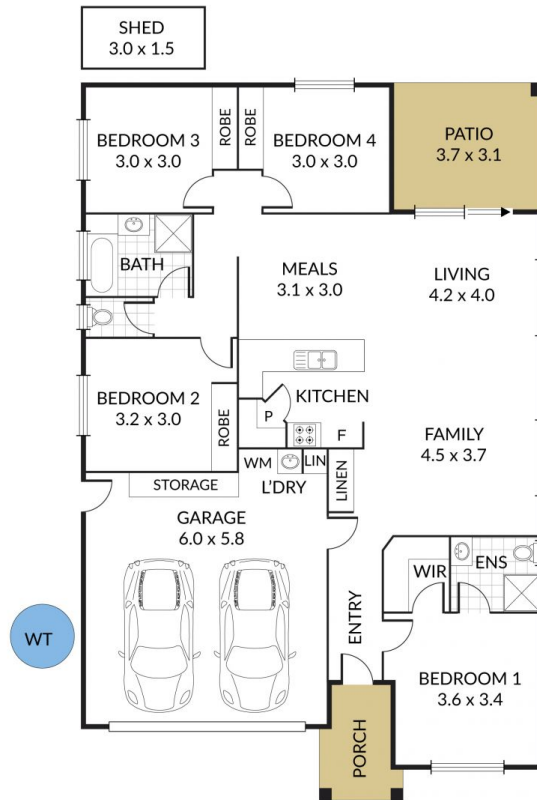

KING & COMPANY
PROPERTY GROUP

NOTE: Every precaution has been taken to verify the accuracy of the above details. However, prospective purchasers are advised to make their own enquiries.