



78/60 Beattie Road Coomera QLD

3 2 2

This one is sure to impress those looking for something to add value to, in a PRIME location. At 78/60 Beattie Road, you have the ease of access to theme parks, Westfield, Costco, and public transport all within a few minutes' drive. Whether you are looking for your first home or an investment property, you are going to want to add this one to your inspection list this weekend!

PROPERTY FEATURES:

- ~ Open plan kitchen, living & dining area with air-conditioning
- ~ Kitchen with dishwasher, electric cooktop & oven
- ~ Main bedroom with ensuite & WIR
- ~ Other two bedrooms with ceiling fans & built-ins
- ~ Main bathroom with bathtub upstairs
- ~ Private paved courtyard with low-maintenance gardens
- ~ Single lock up garage & additional private car park space

Price : \$ 475,000

View : <https://www.kingcompanypg.com/sale/qld/gold-coast/coomera/residential/townhouse/7705093>



Taylor McDonald-Smith
07 3805 2755



Chloe Grieve
07 3805 2755

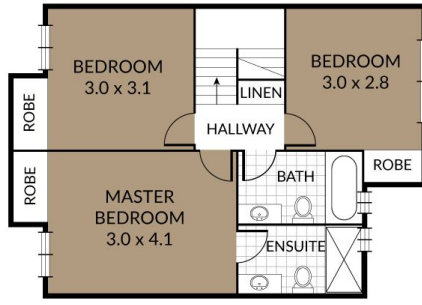

FIRST FLOOR

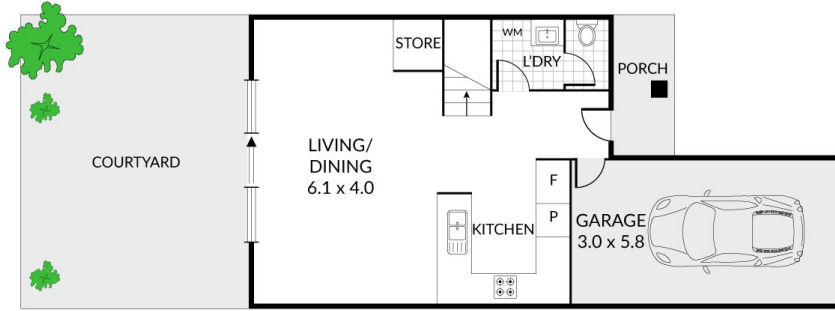

GROUND FLOOR

KING & COMPANY

NOTE: Every precaution has been taken to verify the accuracy of the above details. However, prospective purchasers are advised to make their own enquiries.

78/60 BEATTIE ROAD COOMERA

Internal: 87m ²	3 x 🏠
External: 53m ²	2 x 🚗
Total: 140m ²	1 x 🗝️